

## Upper Control Arm Rear Pickup Point

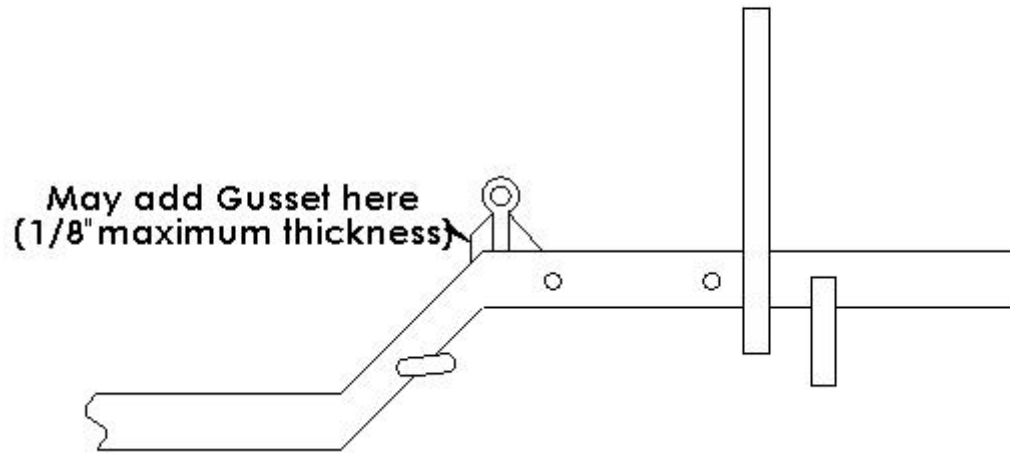

## Front Clip Support

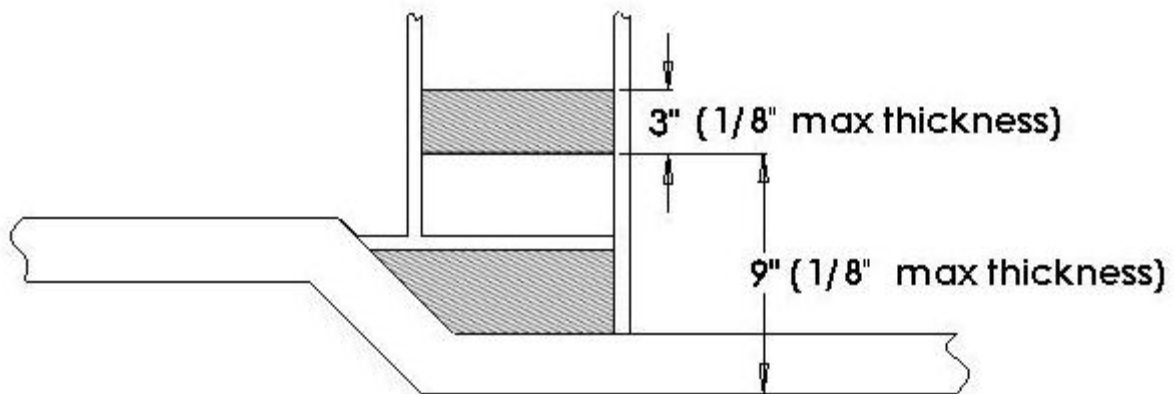

**"From Fire Wall"**

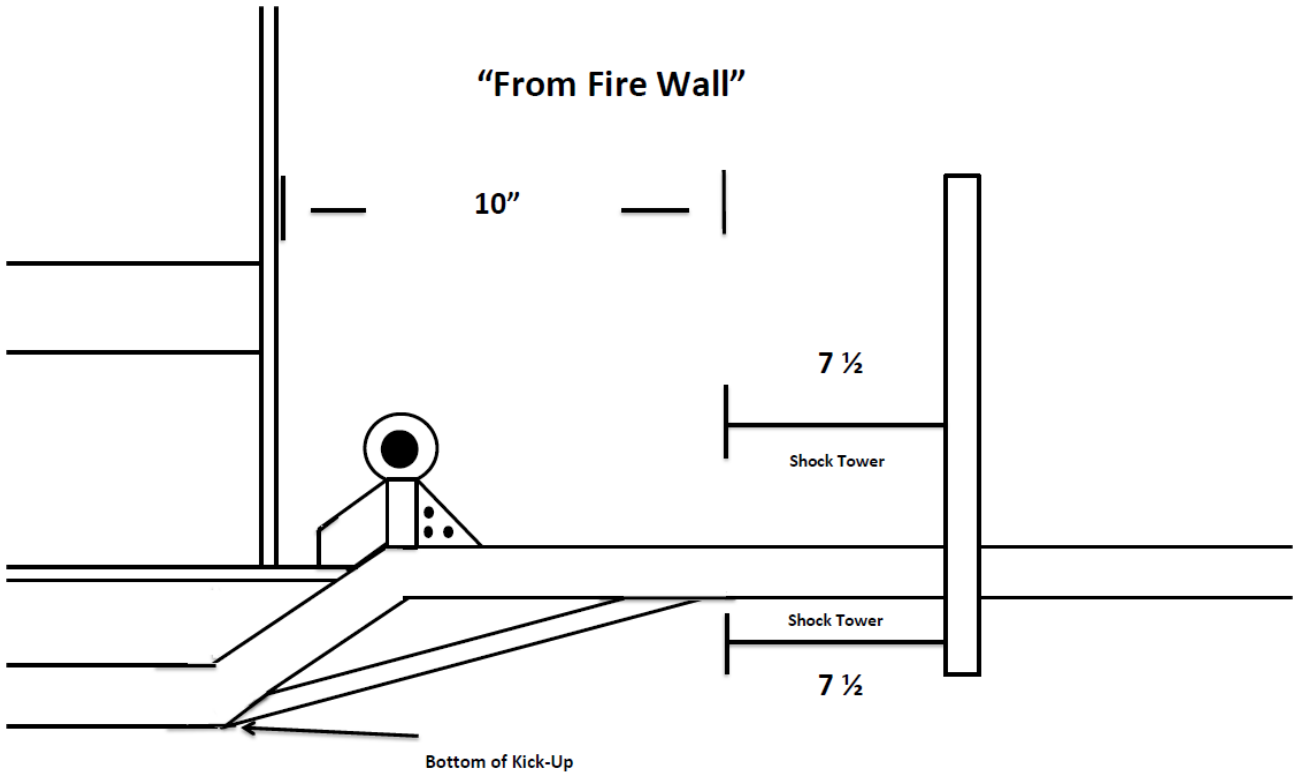

3/4 x 3/4 .083 ERW 10 1/4 Long

## Upper Link & Rear Trailing Arm Pickup Points

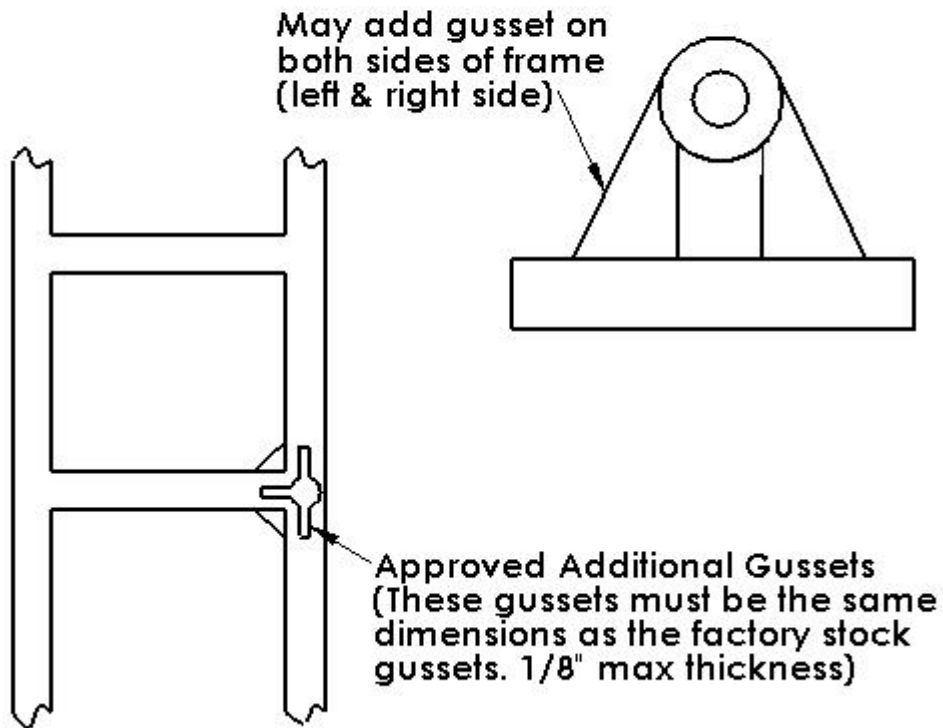

## Rear End Housing Upper Link & Rear Trailing Arm Pickup Point

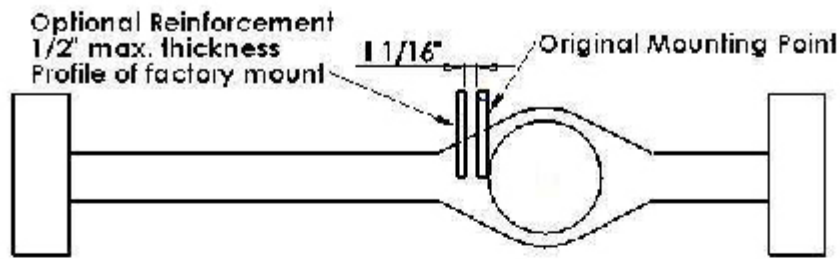

(This reinforcement will secure the opposite side of the rod end of the upper link)

## Back View of Housing

Approved Rear Gussets (Max. 3/16" thick)

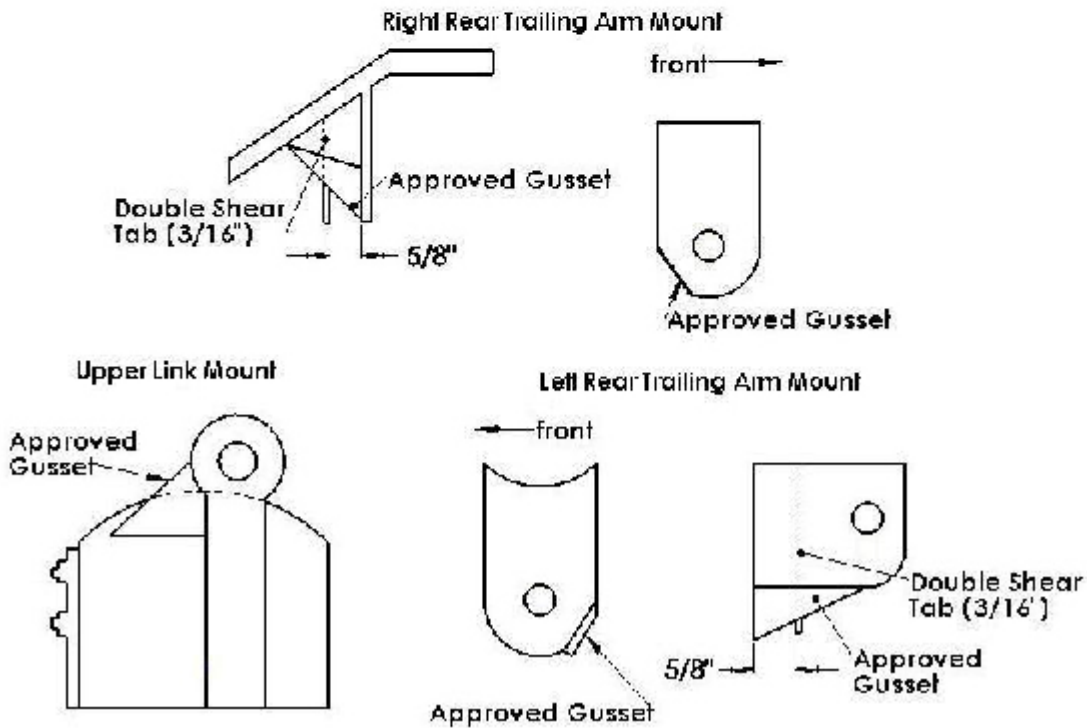

# Steering Rack Plate

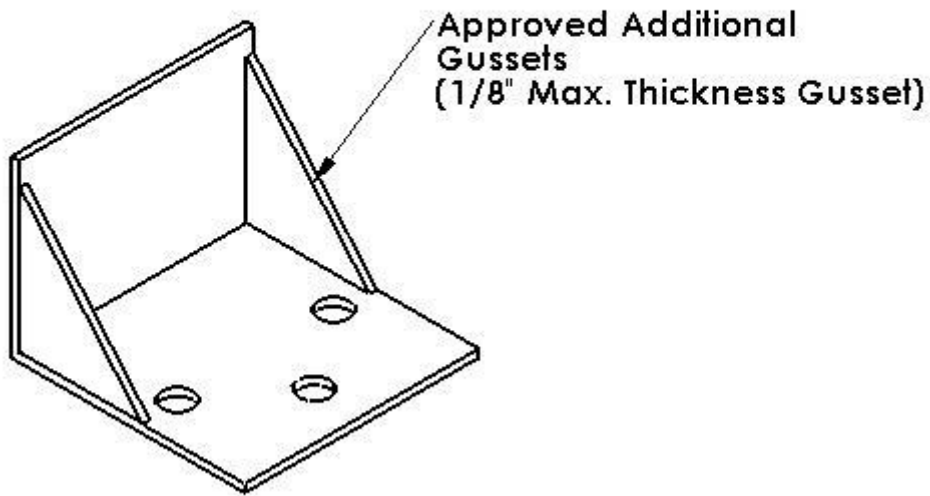

# Upper Link Double Shear Mount (Chassis Side)

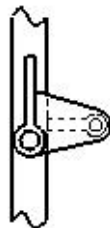
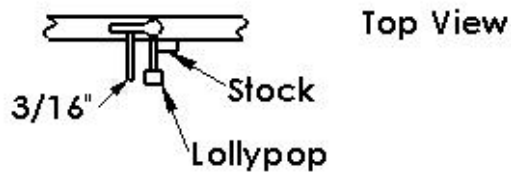
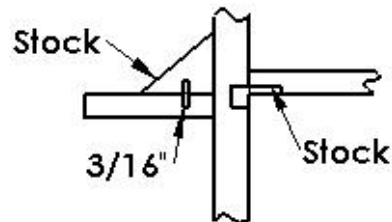

## Shock Tower

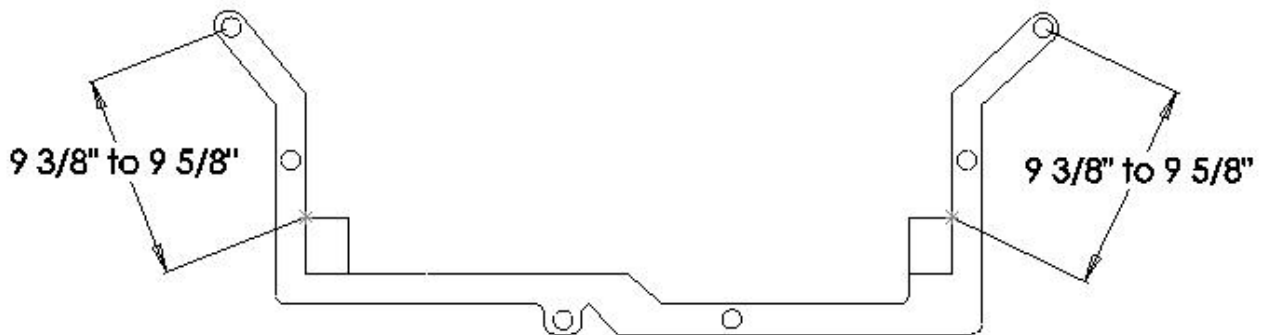

## Legends & Thunder Roadsters Rear End Housing

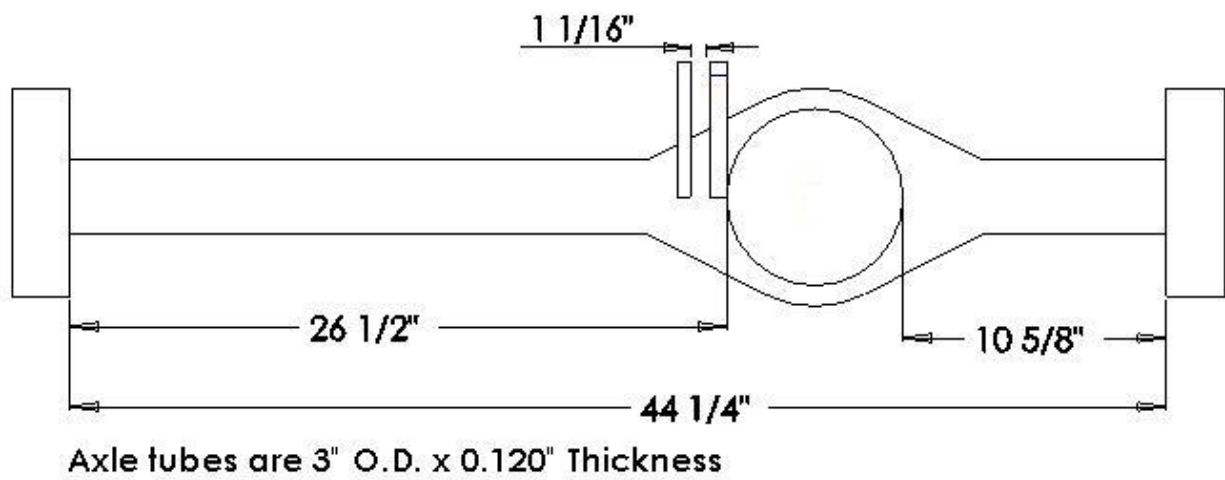

## Legends Shock Tower

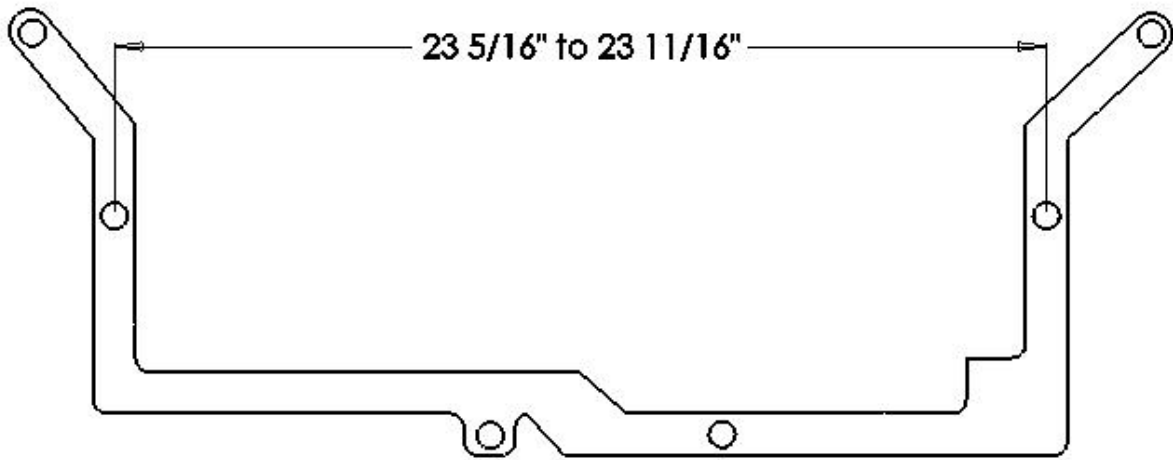

## Legends Left Side Motor Mount Pickup Points & Front Clip Measurements

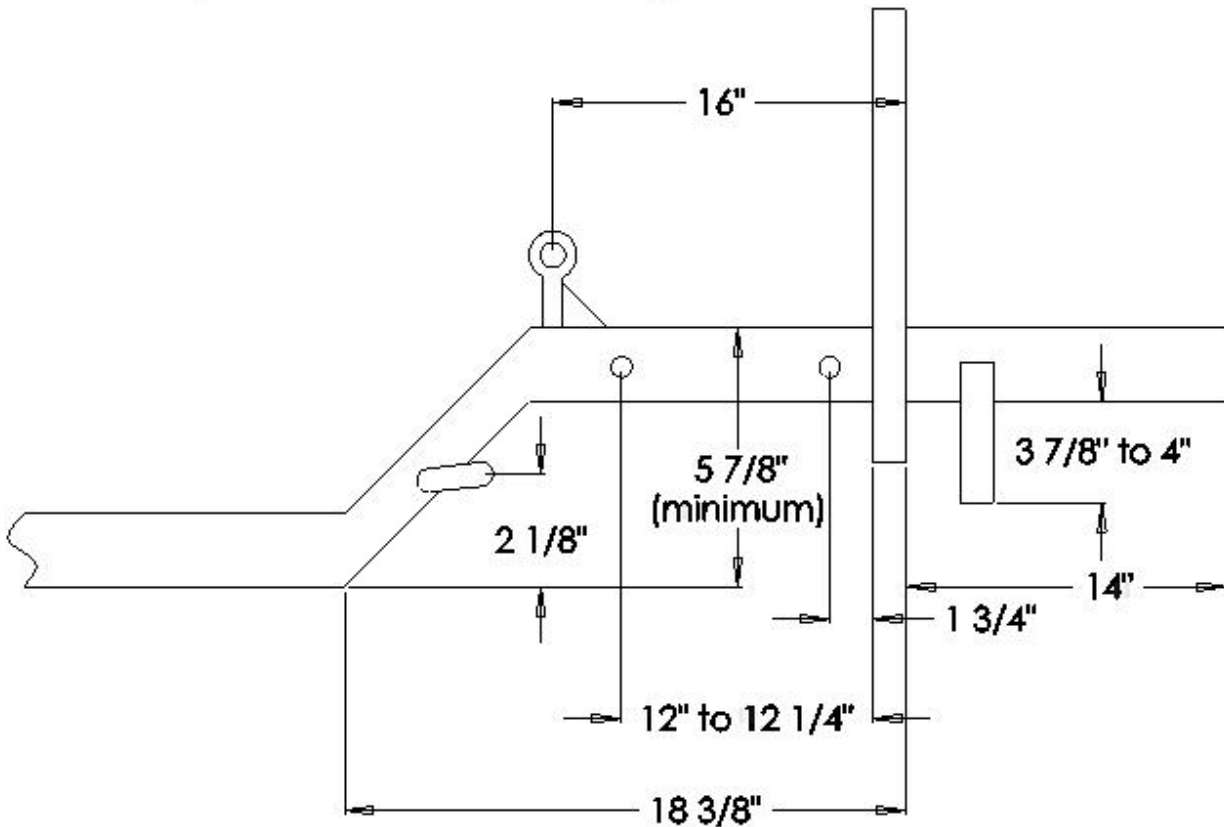

## Legends Right Side Motor Mount

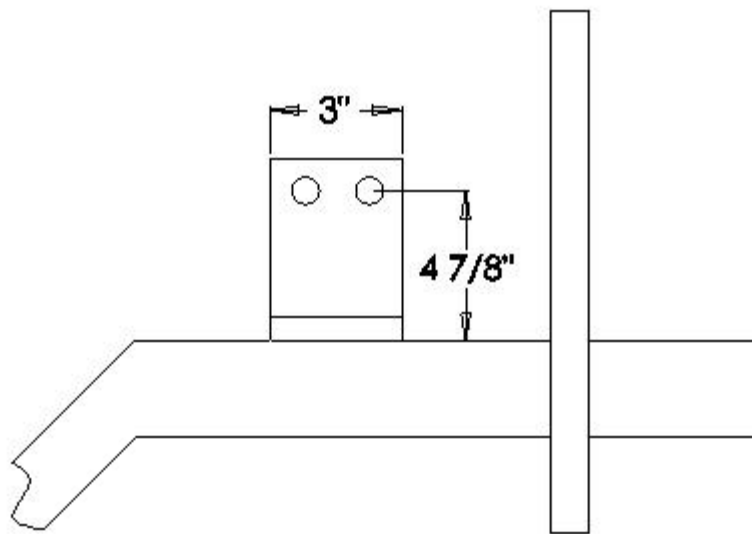

Aluminum mounts or extra holes are illegal.

## Legends Front & Rear Bumper

(1" Steel Tube)

(8 lbs. Max. Weight)

Reinforced Rear Bumper - (9 1/2 lbs. Max. Weight)

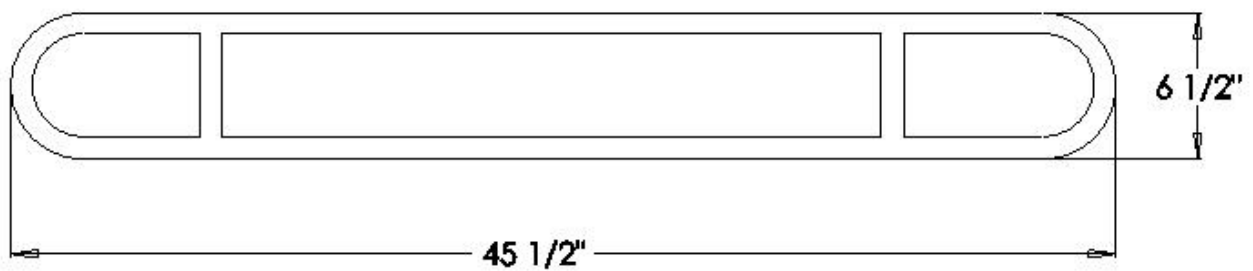



## Legends Right & Left Nerf Bars

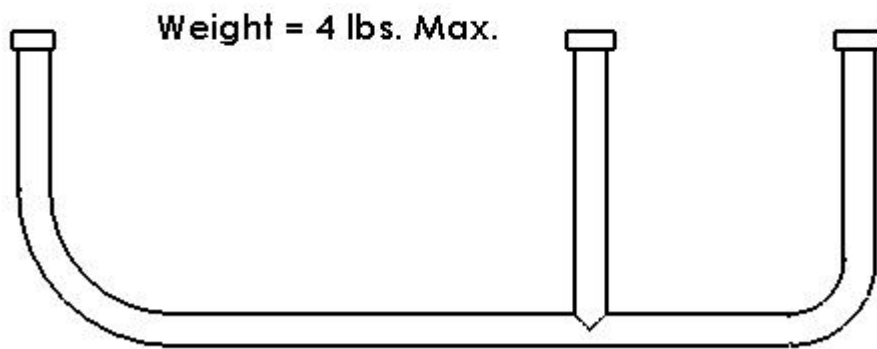

## Legends & Thunder Roadster Sprocket Adapter

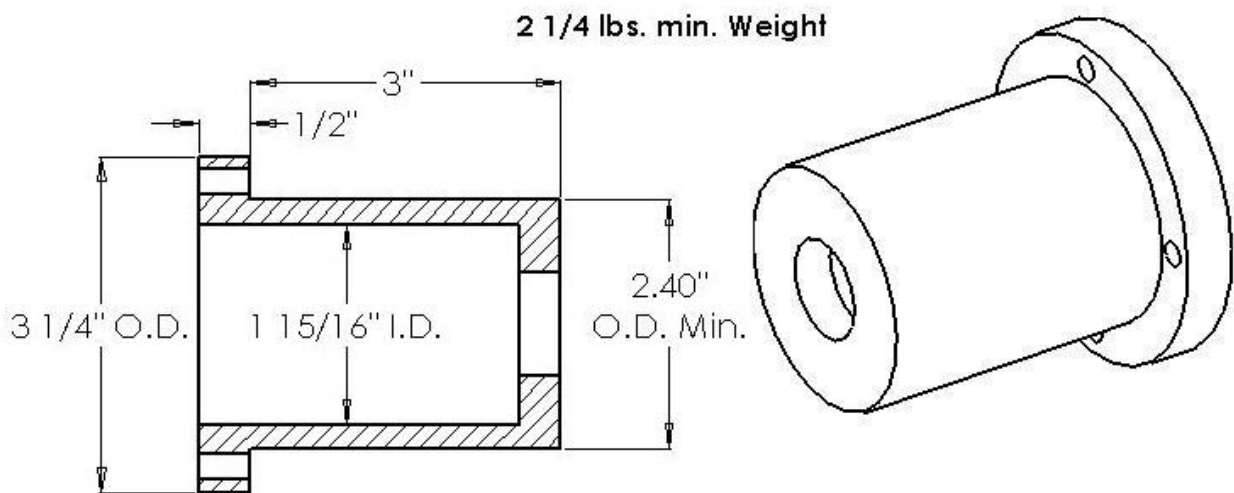

# Legends & Thunder Roadster Brake Drum

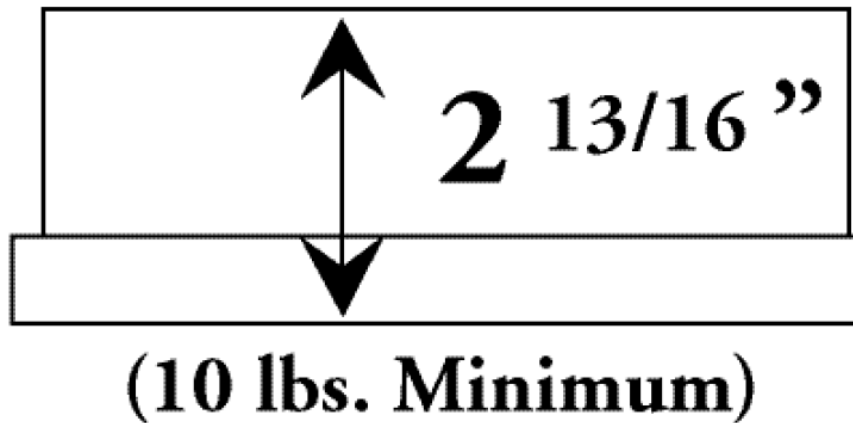

## Legends & Thunder Roadster Axles

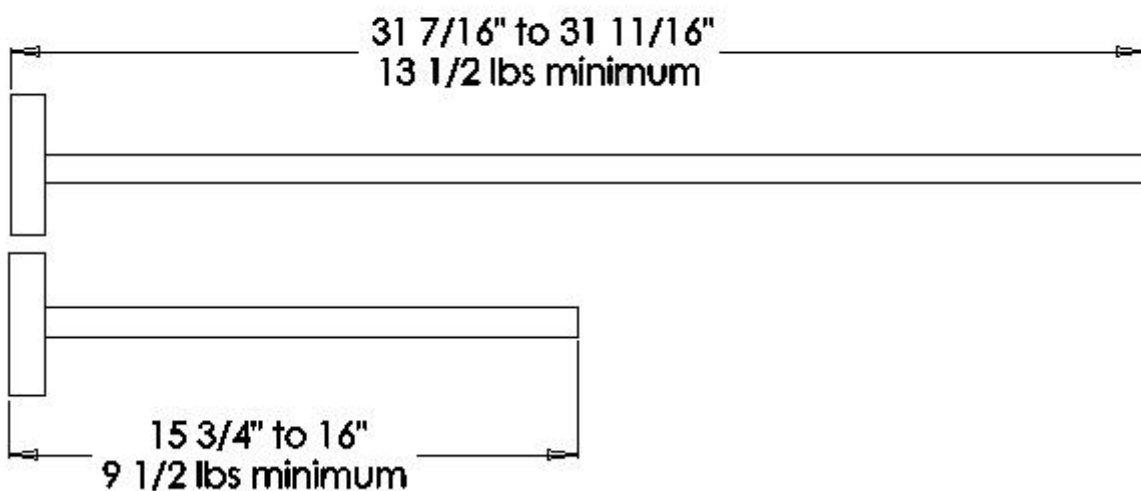

## Legends Upper Control Arm Front Mounting Point

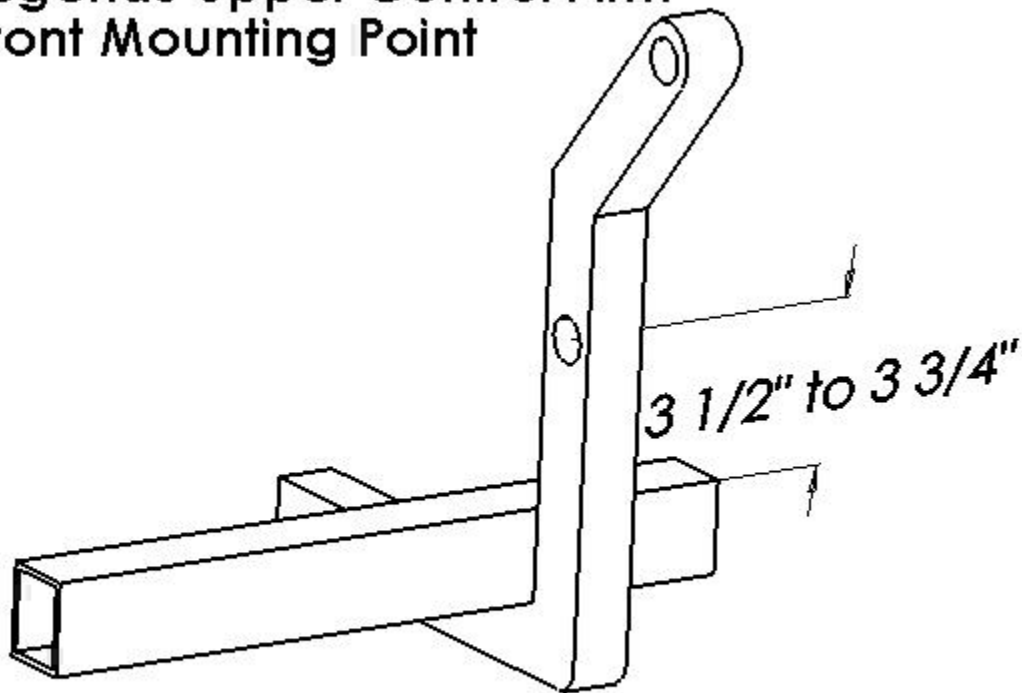

3 1/2" to 3 3/4" (from the top of the frame to the center of the pick-up point holes)

## Legends Suspension Pickup Points

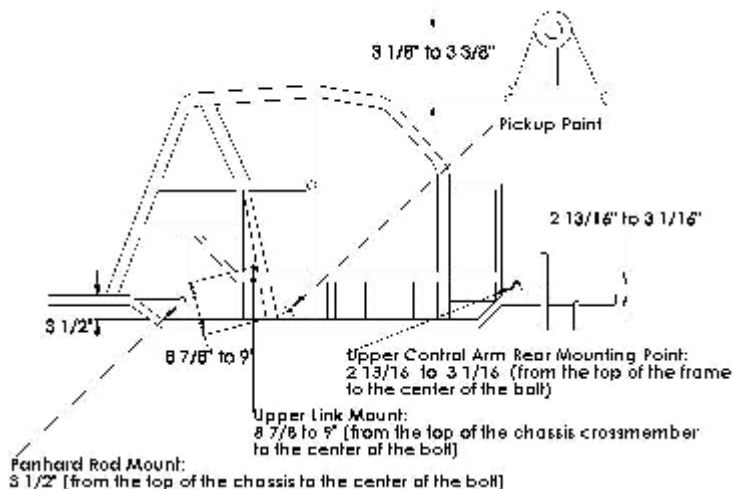

# Legends Left Side Motor Mount

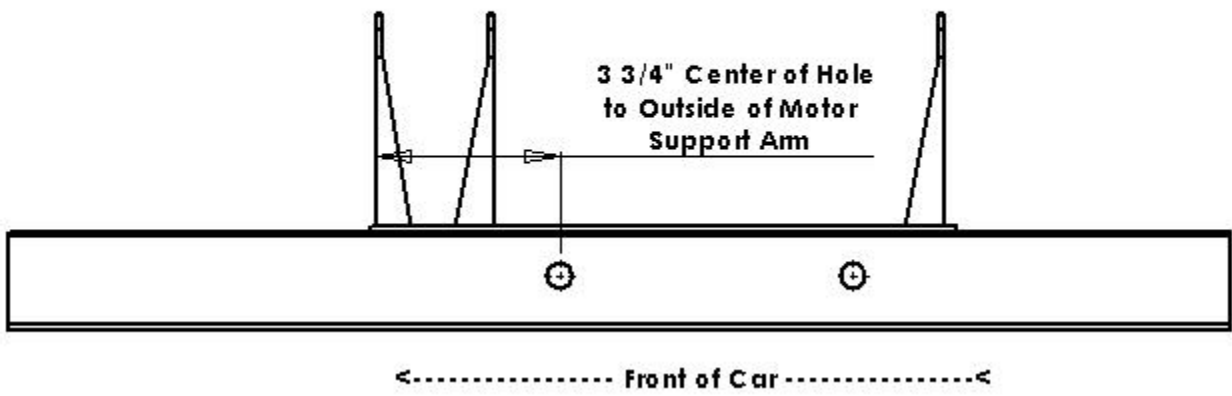
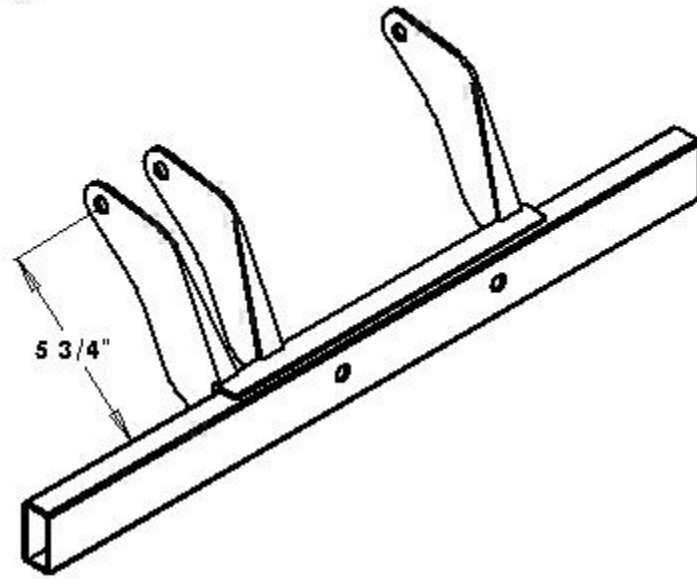

## Legends Battery Box Offset

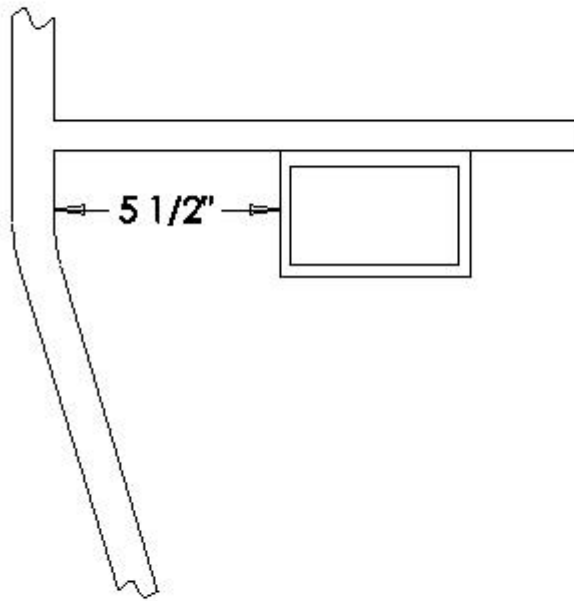

**Note:** The measurement for the battery box offset will be taken at the point closest to the crossmember, from the inside of the framerail to the outside of the battery box.